

OPTIONAL MTG. PAN

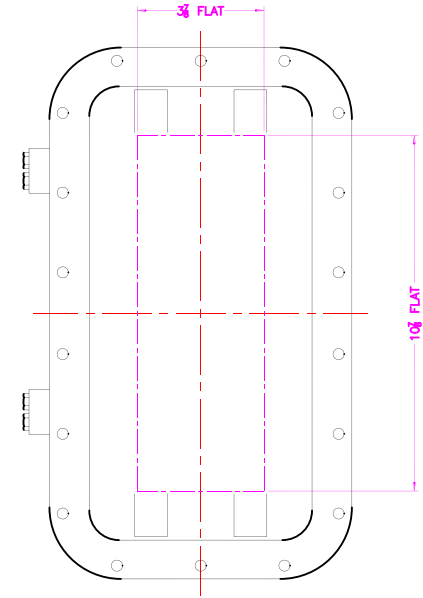

EXISTING GRD. SCREW

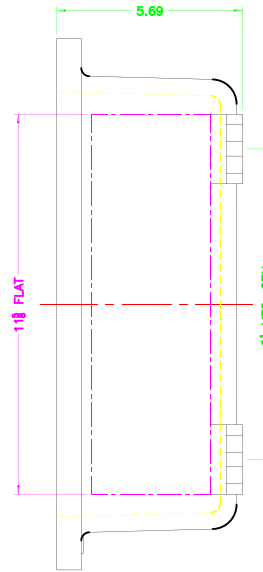
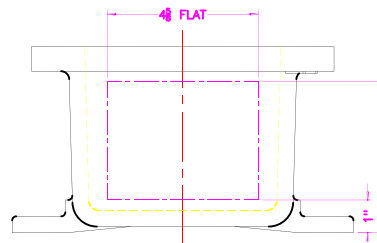

OPTIONAL XHB-2 HINGES

XCE 0613 COVER

NOTES:

COVER DRILLING ALLOWABLE IN XCE ONLY

1. MINIMUM SPACING FROM CENTER OF OPERATOR TO NEAREST FLAT IS 1 1/8.
2. MINIMUM SPACING BETWEEN 3-14 NPSM OPERATOR CENTERS IS 2 1/2 FOR THIS ENCLOSURE.
3. MAXIMUM NUMBER OF OPERATORS IS 4.
4. DIMENSION FROM CENTER LINES OF COVER FOR OPERATORS.
5. DIMENSION FROM CENTER LINE AND BACK OF MTG. LUG FOR CONDUIT.
6. FOR MTG. ENCLOSURE USE 3/8 BOLT.

DO NOT SCALE DRAWING	ADALET A SCOTT FITZGER COMPANY Electrical Systems Cable Accessories	TITLE	
UNLESS OTHERWISE SPECIFIED		MODIFIED XCE/XIF 061305 ENCLOSURE FOR	
CONFORM TO THE FOLLOWING STANDARDS:	DRAWN BY DDH DATE 6-12-01 CHECKED BY DDH DATE 6-12-01 APPROVED BY DDH DATE 6-12-01	DATE APPROVAL DATE APPROVAL DATE APPROVAL	DRAWN BY DDH DATE 6-12-01 CHECKED BY DDH DATE 6-12-01 APPROVED BY DDH DATE 6-12-01
ALL DIMENSIONS IN INCHES UNLESS OTHERWISE SPECIFIED	FINISH TUMBLAST DIM NO XCE/XIF 061305	DIM NO DIM NO DIM NO	DIM NO DIM NO DIM NO
ALL DIMENSIONS IN MILLIMETERS UNLESS OTHERWISE SPECIFIED			DIM NO 10F1