

XCE 1212 COVER

NOTES:

- COVER DRILLING ALLOWABLE IN XCE ONLY
1. MINIMUM SPACING FROM CENTER OF OPERATOR TO NEAREST FLAT IS 1 1/8.
 2. MINIMUM SPACING BETWEEN 3-14 NPSM OPERATOR CENTERS IS 3 FOR THIS ENCLOSURE.
 3. MAXIMUM NUMBER OF OPERATORS IS 9.
 4. DIMENSION FROM CENTER LINES OF COVER FOR OPERATORS.
 5. DIMENSION FROM CENTER LINE AND BACK OF MTG. LUG FOR CONDUIT.
 6. FOR MTG. ENCLOSURE USE 1/2 BOLT.

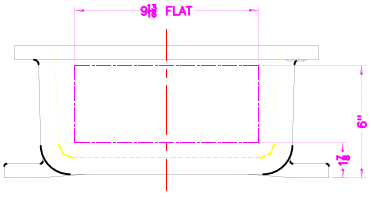

DO NOT SCALE DRAWING UNLESS OTHERWISE SPECIFIED DIMENSIONS TO DIMENSION LINES DIMENSIONS TO CENTER UNLESS NOTED OTHERWISE ALL DIMENSIONS UNLESS NOTED OTHERWISE ARE IN INCHES UNLESS NOTED OTHERWISE UNLESS OTHERWISE SPECIFIED DIMENSIONS ARE TO CENTER UNLESS NOTED OTHERWISE DIMENSIONS TO CENTER UNLESS NOTED OTHERWISE DIMENSIONS TO CENTER UNLESS NOTED OTHERWISE DIMENSIONS TO CENTER UNLESS NOTED OTHERWISE	ADALET <small>A SCOTT PETERSON COMPANY</small> Reliability Solutions Cable Accessories	TITLE MODIFIED XCE/XIF 121206 ENCLOSURE FOR		
	DATE TO BEING REVISED SEE REVISED SPECIFICATIONS AND PREVIOUS EDITIONS IF ANY. PREVIOUS EDITIONS ARE TO BE DELETED. THE REVISIONS AND ALL DIMENSIONS SHALL BE INDICATED BY A YELLOW HIGHLIGHT COLOR WHEN YOU DESIGN YOUR REVISED DRAWING. UNLESS OTHERWISE SPECIFIED DIMENSIONS ARE TO CENTER UNLESS NOTED OTHERWISE UNLESS OTHERWISE SPECIFIED DIMENSIONS ARE TO CENTER UNLESS NOTED OTHERWISE UNLESS OTHERWISE SPECIFIED DIMENSIONS ARE TO CENTER UNLESS NOTED OTHERWISE	DRAWN BY DDH	DATE 11-12-01	
	3RD APPROVAL [Signature]	1ST APPROVAL [Signature]	DRAW SCALE 1=3.5	
	2ND APPROVAL [Signature]	DATE D	1ST APPROVAL [Signature]	
	4TH APPROVAL [Signature]	DATE [Blank]		
	5TH APPROVAL [Signature]	DATE [Blank]		
PART TUMBLAST	DATE XCE/XIF 121206	DATE 10F1		