

OPTIONAL MTG. PAN

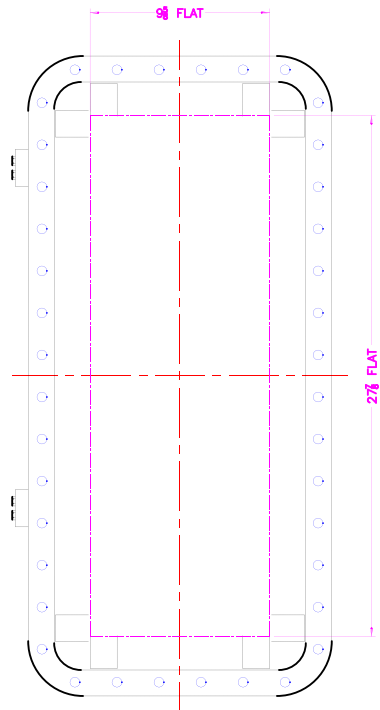

OPTIONAL XHC-2 HINGES

EXISTING GRD. SCREW

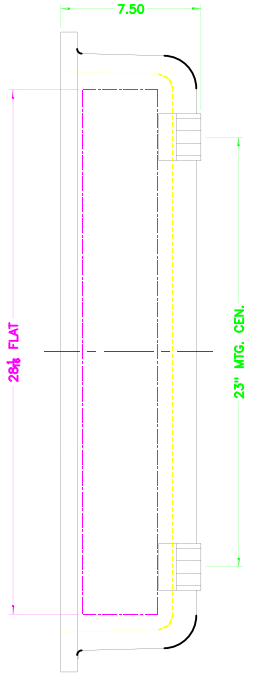
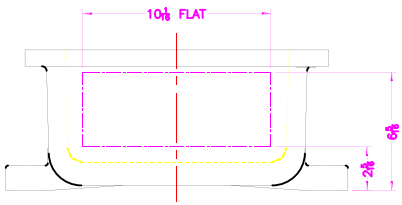

XCE 1230 COVER

COVER DRILLING ALLOWABLE IN XCE ONLY

NOTES:

1. MINIMUM SPACING FROM CENTER OF OPERATOR TO NEAREST FLAT IS 1 1/8.
2. MINIMUM SPACING BETWEEN 1/4-14 NPSM OPERATOR CENTERS IS 3 FOR THIS ENCLOSURE.
3. MAXIMUM NUMBER OF OPERATORS IS 27.
4. DIMENSION FROM CENTER LINES OF COVER FOR OPERATORS.
5. DIMENSION FROM CENTER LINE AND BACK OF MTG. LUG FOR CONDUIT.
6. FOR MTG. ENCLOSURE USE 3/8 BOLT.

DO NOT SCALE DIMENSIONS UNLESS OTHERWISE NOTED. DIMENSIONS ARE IN INCHES UNLESS OTHERWISE NOTED. DIMENSIONS IN PARENTHESES ARE FOR INFORMATION ONLY. DIMENSIONS IN PARENTHESES ARE NOT TO BE USED FOR FABRICATION.	ADALET A SCOTT PETERSON COMPANY Enclosure Systems Cable Accessories	TITLE MODIFIED XCE/XIF 123006 ENCLOSURE FOR
DATE OF REVISION: 11/13/01	DRAWN BY: DDH DATE: 11-13-01 CHECKED BY: [blank] DATE: [blank]	DATE: 11-13-01 DRAWN BY: DDH DATE: 11-13-01
PROJECT NO.: [blank] DRAWING NO.: [blank] SHEET NO.: [blank]	APPROVAL: [blank] TUMBLAST XCE/XIF 123006	DATE: 11-13-01 DRAWN BY: DDH DATE: 11-13-01 CHECKED BY: [blank] DATE: [blank]
SCALE: 1=3.5 SHEET: D TOTAL SHEETS: 10F1		