

REV	REVISION	BY	CHK	DATE

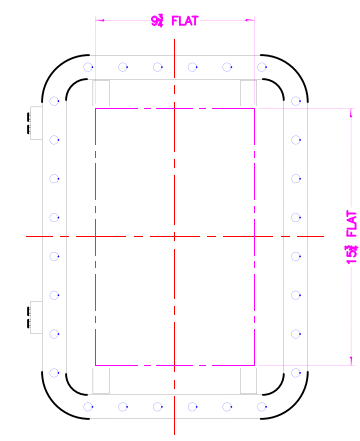

XCE 1218 COVER

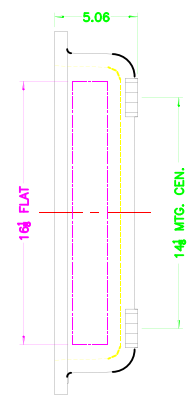
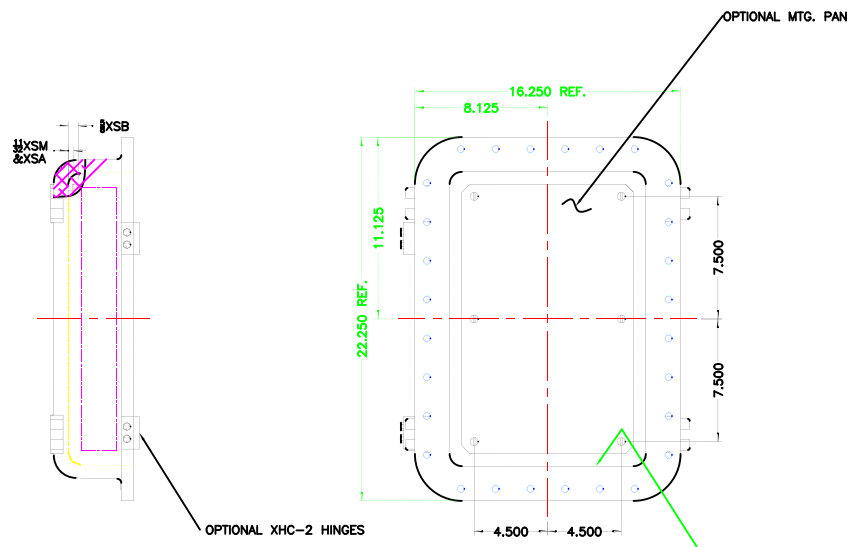
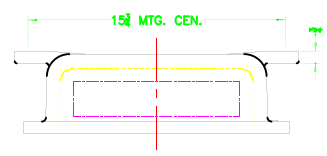
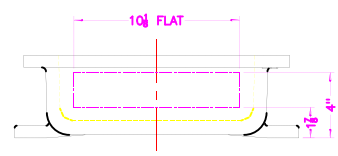

EXISTING GRD. SCREW

- NOTES:
- COVER DRILLING ALLOWABLE IN XCE ONLY
1. MINIMUM SPACING FROM CENTER OF OPERATOR TO NEAREST FLAT IS 1 1/8".
 2. MINIMUM SPACING BETWEEN 3-14 NPSM OPERATOR CENTERS IS 3" FOR THIS ENCLOSURE.
 3. MAXIMUM NUMBER OF OPERATORS IS 15.
 4. DIMENSION FROM CENTER LINES OF COVER FOR OPERATORS.
 5. DIMENSION FROM CENTER LINE AND BACK OF MTG. LUG FOR CONDUIT.
 6. FOR MTG. ENCLOSURE USE 1/2 BOLT.

DO NOT SCALE DIMENSIONS UNLESS OTHERWISE SPECIFIED USE DIMENSIONS OR DIMENSIONS OF UNLESS OTHERWISE SPECIFIED DIMENSIONS IN INCHES UNLESS OTHERWISE SPECIFIED DIMENSIONS IN MILLIMETERS UNLESS OTHERWISE SPECIFIED DIMENSIONS IN FEET UNLESS OTHERWISE SPECIFIED DIMENSIONS IN METERS UNLESS OTHERWISE SPECIFIED DIMENSIONS IN INCHES UNLESS OTHERWISE SPECIFIED DIMENSIONS IN MILLIMETERS UNLESS OTHERWISE SPECIFIED DIMENSIONS IN FEET UNLESS OTHERWISE SPECIFIED DIMENSIONS IN METERS UNLESS OTHERWISE SPECIFIED	<p>ADALET A SCOTT PETERSON COMPANY Industrial Equipment</p> <p>DATE TO BE REVIEWED: 11-12-01 DRAWN BY: DDH DATE: 11-12-01 CHECKED BY: DDH DATE: 11-12-01 APPROVED BY: DDH DATE: 11-12-01 MFG APPROVAL: DDH DATE: 11-12-01 FINISH: TUMBLAST DATE: 11-12-01 CMT NO: XCE 121804</p>	<p>FILE: MODIFIED XCE 121804 ENCLOSURE FOR</p> <p>DATE: 11-12-01 DRAWN BY: DDH DATE: 11-12-01 CHECKED BY: DDH DATE: 11-12-01 APPROVED BY: DDH DATE: 11-12-01 MFG APPROVAL: DDH DATE: 11-12-01 FINISH: TUMBLAST DATE: 11-12-01 CMT NO: XCE 121804</p>
--	---	--