

OPTIONAL MTG. PAN

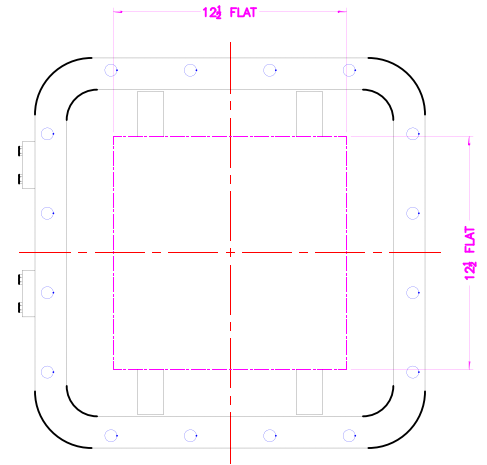

XCE 1616 COVER

EXISTING GRD. SCREW

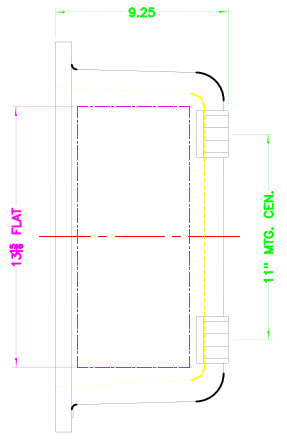
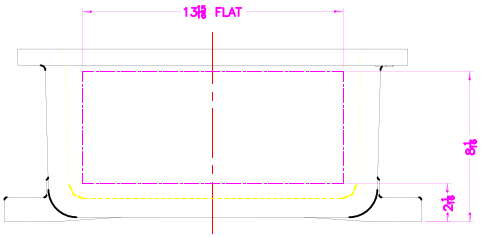

NOTES:

- COVER DRILLING ALLOWABLE IN XCE ONLY
1. MINIMUM SPACING FROM CENTER OF OPERATOR TO NEAREST FLAT IS 1 1/8.
  2. MINIMUM SPACING BETWEEN 3/4-14 NPSM OPERATOR CENTERS IS 3/2 FOR THIS ENCLOSURE.
  3. MAXIMUM NUMBER OF OPERATORS IS 16.
  4. DIMENSION FROM CENTER LINES OF COVER FOR OPERATORS.
  5. DIMENSION FROM CENTER LINE AND BACK OF MTG. LUG FOR CONDUIT.
  6. FOR MTG. ENCLOSURE USE 3/8 BOLT.

DO NOT SCALE DRAWING	DATE: 11-14-01	SCALE: 1=3.5	TITLE: MODIFIED XCE/XIF 161608 ENCLOSURE FOR
UNLESS OTHERWISE SPECIFIED	DESIGN: DDH	DWG. NO. D	DATE: 11-14-01
CONSTRUCTION DIMENSIONS	APPROVAL: [Signature]	DWG. NO. D	DATE: 11-14-01
FINISH: TUMBLAST	APPROVAL: [Signature]	DWG. NO. D	DATE: 11-14-01
DRY NO. XCE/XIF 161608		REV. 10F1	