

WINDOW SCREW COVER

Window Screw Cover Explosionproof Meter Housings

- Drilled and tapped to specification, attach layout sheet.
- Dimensions are internal.

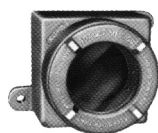

XJDGCH N4
XJDFGCH N4
4 1/8" x 4 1/8" x 3"

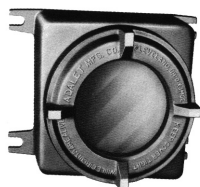

XJMC GCH N4
6 3/4" x 6 3/4" x 3"



XJTGCH N4
XJTFGCH N4
5 13/16" x 6 5/16" x 4"

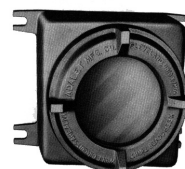

XJMGCH N4
6 3/4" x 6 3/4" x 8"

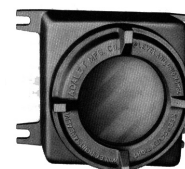

XJMAGCH N4
6 3/4" x 6 3/4" x 5"



XJXGCH N4
4 7/8" x 4 7/8" x 3 1/16"



XJLGCH N4
6" X 6" x 3 5/16"



XJNGCH N4, 6 & 12
11 1/2" x 12 3/4" x 6"
11 1/2" x 12 3/4" x 12 1/8"

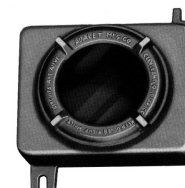

XJHAGCH N4
7 3/16" x 9 3/16" x 4"



XJHBGCH N4
7 1/4" x 9 1/8" x 6"



XJHCGCH N4
7 3/4" x 10 5/16" x 5"



XJKGCH N4
9 1/8" x 11 1/2" x 6 1/16"



XJKAGCH N4
9 1/2" x 11 1/2" x 8 1/2"



XJWHGCH N4
6 7/8" I.D. x 4 1/4"
Cover Opening 6 7/8"



XJWTGCH N4
5 3/8" I.D. x 3 3/4"
Cover Opening 5 3/8"

CERTIFICATIONS

Class I, Div. 1, Groups B, C, D
Class II, Groups E, F, G
NEMA Type 4

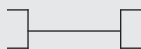

UL 1203
CSA C22.2 No. 25 & 30
UL 50



WINDOW SCREW COVER

Window Screw Cover Explosionproof Meter Housings

- Drilled and tapped to specification, attach layout sheet.
- Dimensions are in nominal internal.

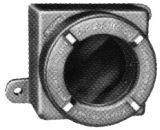

XJDGCHX N4
XJDFGCHX N4
4 1/8" x 4 1/8" x 3"

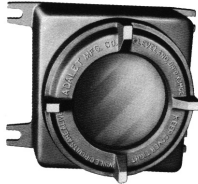

XJMCGCHX N4
6 3/4" x 6 3/4" x 3"



XJTGCHX N4
XJTFGCHX N4
5 13/16" x 6 9/16" x 4"



XJMGCHX N4
6 3/4" x 6 3/4" x 8"

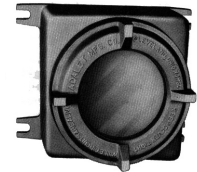

XJMAGCHX N4
6 3/4" x 6 3/4" x 5"



XJXGCHX N4
4 7/8" x 4 7/8" x 3 1/16"



XJLGCHX N4
6" x 6" x 3 9/16"



XJNGCHX N4, 6 & 12
11 1/2" x 12 3/4" x 6"
11 1/2" x 12 3/4" x 12 1/8"

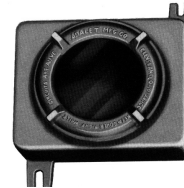

XJHAGCHX N4
7 3/16" x 9 3/16" x 4"



XJHBGCHX N4
7 1/4" x 9 1/8" x 6"



XJHCGCHX N4
7 3/4" x 10 5/16" x 5"



XJKGCHX N4
9 1/2" x 11 1/2" x 6 1/8"



XJKAGCHX N4
9 1/2" x 11 1/2" x 8 1/2"



XJWHGCHX N4
6 7/8" I.D. x 4 1/4"
Cover Opening 6 7/8"



XJWGTGCHX N4
5 3/8" I.D. x 3 3/4"
Cover Opening 5 3/8"

CERTIFICATIONS

Class I, Div. 1, Groups B, C, D
Class II, Groups E, F, G
Class III
Class I, Zone 1, AEx d IIB+H2
Ex d IIB+H2
0539 Ⓢ II 2GD (Optional)*
EEx d IIB+H2 (Optional)*
IP 66
NEMA Type 4



UL 1203
CSA C22.2 No. 25 & 30
UL 60079-0/UL 60079-1
CSA 60079-0/CSA 60079-1
ATEX Directive 94/9/EC
EN 50014, EN50018
IEC 60529
UL 50



*specify ATEX if required

EXPLOSIONPROOF
METER HOUSINGS

WINDOW SCREW COVER

Window Screw Cover Explosionproof Meter Housings

STANDARD FEATURES

- Copper-free aluminum casting designed for specific size instruments and meters.
- XJDFGCH: Designed for the mounting of 3 1/2" round instruments and meters.
- Furnished with an integrally cast inside mounting flange.
- Also available without the flange as the Type XJDGC(X), for equipment other than 3 1/2" round instruments and meters.
- XJTFGCH: Designed for 4 1/2" round and 3 1/2" rectangular meters
- Furnished with cast inside mounting ears and adapter plate for meter mounting.
- Optional mounting pans available.

NOMINAL DIMENSIONS

CAT. NUMBER	CONDUIT SIZE	INSIDE DIM.			DIM UNDER GLASS	THROAT OPENING	MAX METER FACE DIA.	MTNG HOLE SIZE	WEIGHT (LBS)
		W	L	D					
XJDFGCH N4	2	4 1/8	4 1/8	3	4 1/16	2 7/8	3 1/2	7/16	6
XJDGC N4	2	4 1/8	4 1/8	3	4 1/16	3 3/4	3 1/2	7/16	6
XJMCGCH N4	2	6 3/4	6 3/4	3	4 5/8	7	5 1/4	7/16	17
XJTFGCH N4	2	5 13/16	6 9/16	4	4 11/16	5 3/8	4 1/2	1/2	13

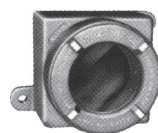

XJDFGCH N4
XJDFGCHX N4

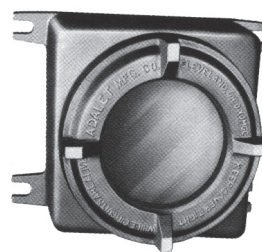
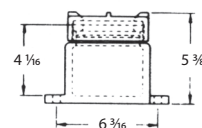
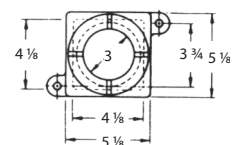

XJMCGCH N4
XJMCGCHX N4

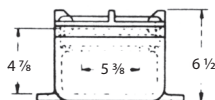
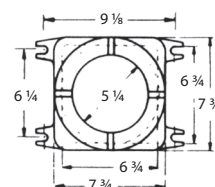

XJTFGCH N4
XJTFGCHX N4

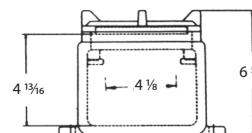
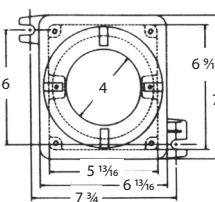

CERTIFICATIONS

Class I, Div. 1, Groups B, C, D
Class II, Groups E, F, G
NEMA Type 4

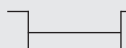

UL 1203
CSA C22.2 No. 25 & 30
UL 50



WINDOW SCREW COVER

Window Screw Cover Explosionproof Meter Housings

STANDARD FEATURES

- Copper-free aluminum casting designed for specific sizes, instruments, and meters.
- Optional mounting pans available.

NOMINAL DIMENSIONS

CAT. NUMBER	CONDUIT SIZE	INSIDE DIM.			DIM UNDER GLASS	THROAT OPENING	MAX METER FACE DIA.	MTNG HOLE SIZE	WEIGHT (LBS)
		W	L	D					
XJMGCH N4	2	6 3/4	6 3/4	8	9 7/8	5 3/8	5 1/4	7/16	22
XJMGCH N4	2	6 3/4	6 3/4	5	6 7/8	5 3/8	5 1/4	7/16	19

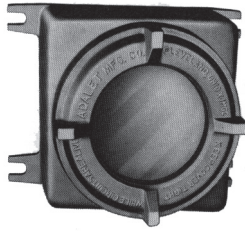
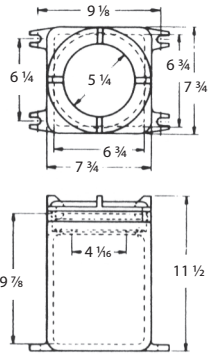

XJMGCH N4
XJMGCHX N4

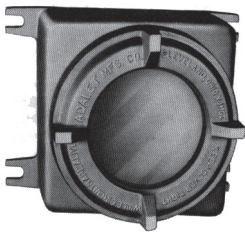
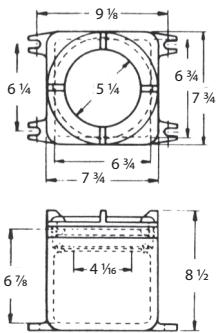

XJMAGCH N4
XJMAGCHX N4

EXPLOSIONPROOF
METER HOUSINGS

CERTIFICATIONS



Class I, Div. 1, Groups B, C, D
Class II, Groups E, F, G
NEMA Type 4

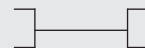

UL 1203
CSA C22.2 No. 25 & 30
UL 50

WINDOW SCREW COVER

Window Screw Cover Explosionproof Meter Housings

STANDARD FEATURES

- Copper-free aluminum casting.
- This series of housings with glass windows are suitable for mounting relays and control equipment as well as meters and instruments.
- The wall section of the housings are of sufficient thickness to provide the required (5) full threads for conduit entrances as listed.
- The housings are stocked blank and can be drilled and tapped to your specifications. (A layout sketch should accompany the order.)
- Mounting posts, rings, studs and other accessories can be furnished.
- Optional mounting pans available.

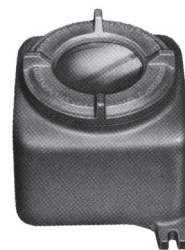

XJXGCH N4
XJXGCHX N4

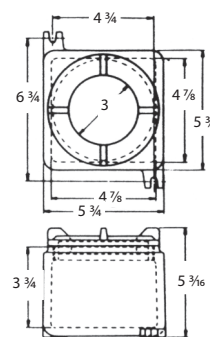

NOMINAL DIMENSIONS

CAT. NUMBER	CONDUIT SIZE	INSIDE DIM.			COVER OPENING	WINDOW OPENING	MTNG HOLE SIZE	WEIGHT (LBS)
		W	L	D				
XJXGCH N4	2	4 7/8	4 7/8	3 1/16	3 3/4	4 3/4	1 1/32	6 1/2
XJLGCH N4	2	6	6	3 9/16	4 1/8	5 3/8	7/16	11
XJTGCH N4	2	5 13/16	6 9/16	4	4 11/16	5 3/8	1/2	13

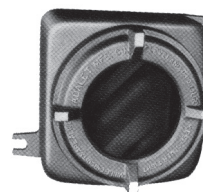

XJLGCH N4
XJLGCHX N4

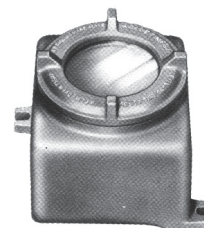
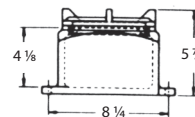
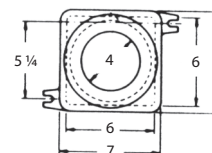

XJTGCH N4
XJTGCHX N4

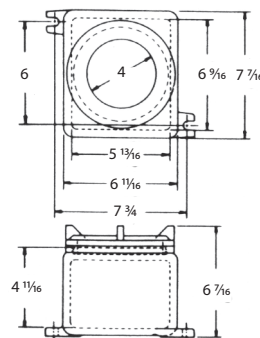

CERTIFICATIONS

Class I, Div. 1, Groups B, C, D
Class II, Groups E, F, G
NEMA Type 4

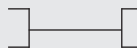

UL 1203
CSA C22.2 No. 25 & 30
UL 50



WINDOW SCREW COVER

Window Screw Cover Explosionproof Meter Housings

STANDARD FEATURES

- Copper-free aluminum casting.
- This series of housings with glass windows are suitable for mounting relays and control equipment as well as meters and instruments.
- The wall section of the housings are of sufficient thickness to provide the required (5) full threads for conduit entrances as listed.
- The housings are stocked blank and can be drilled and tapped to your specifications. (A layout sketch should accompany the order.)
- Mounting posts, rings, studs and other accessories can be furnished.
- Optional mounting pans available.

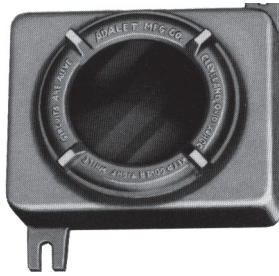
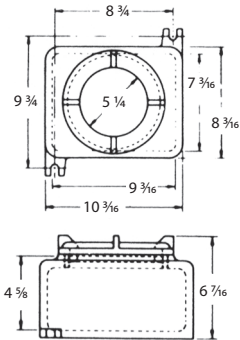

XJHAGCH N4
XJHAGCHX N4

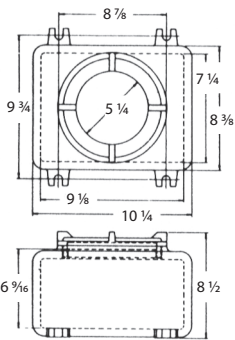

XJHBGCH N4
XJHBGCHX N4

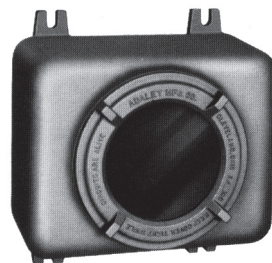
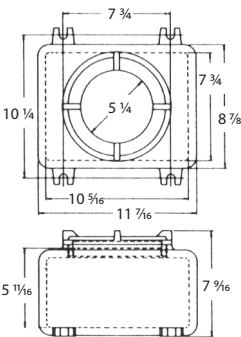

XJHCGCH N4
XJHCGCHX N4

NOMINAL DIMENSIONS

CAT. NUMBER	CONDUIT SIZE	INSIDE DIM.			COVER OPENING	WINDOW OPENING	MTNG HOLE SIZE	WEIGHT (LBS)
		W	L	D				
XJHAGCH N4	2	7 3/16	9 3/16	4	4 5/8	7	9/16	17
XJHBGCH N4	2	7 1/4	9 1/8	6	6 9/16	7	9/16	23
XJHCGCH N4	2	7 3/4	10 5/16	5	5 1/16	7	9/16	23

CERTIFICATIONS

Class I, Div. 1, Groups B, C, D
Class II, Groups E, F, G
NEMA Type 4

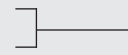

UL 1203
CSA C22.2 No. 25 & 30
UL 50



EXPLOSIONPROOF
METER HOUSINGS

WINDOW SCREW COVER

Window Screw Cover Explosionproof Meter Housings

STANDARD FEATURES

- Copper-free aluminum casting.
- Large cover opening enhances mounting pan installation.
- Availability of two depths offers a selection for efficient packaging of components.
- Suitable for mounting relays and control equipment as well as meters and instruments.
- The wall section of the housings are of sufficient thickness to provide the required (5) full threads for conduit entrances as listed.
- The boxes are drilled and tapped to specification. (A layout sketch should be attached to each order.)
- Mounting posts, rings, studs and other accessories can be furnished.
- Optional mounting pans available.

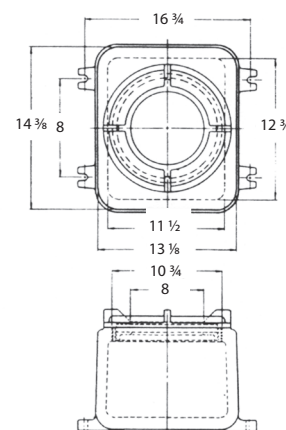

XJNGCH N4
XJNGCHX N4

NOMINAL DIMENSIONS

CAT. NUMBER	CONDUIT SIZE	INSIDE DIM.			OVERALL HEIGHT	COVER OPENING SIZE	WINDOW OPENING	MTNG HOLE SIZE	WEIGHT (LBS)
		W	L	D					
XJNGCH6 N4	2	11 1/2	12 3/4	6	9 13/16	10 3/4	8	5/8	63
XJNGCH12 N4	2	11 1/2	12 3/4	12 1/8	15 15/16	10 3/4	8	5/8	87

CERTIFICATIONS

Class I, Div. 1, Groups B, C, D
Class II, Groups E, F, G
NEMA Type 4

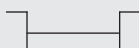

UL 1203
CSA C22.2 No. 25 & 30
UL 50



WINDOW SCREW COVER

Window Screw Cover Explosionproof Meter Housings

STANDARD FEATURES

- Copper-free aluminum casting.
- This series of housings with glass windows are suitable for mounting relays and control equipment as well as meters and instruments.
- The wall section of the housings are of sufficient thickness to provide the required (5) full threads for conduit entrances as listed.
- The housings are stocked blank and can be drilled and tapped to your specifications. (A layout sketch should accompany the order.)
- Mounting posts, rings, studs and other accessories can be furnished.
- Optional mounting pans available.

NOMINAL DIMENSIONS

CAT. NUMBER	CONDUIT SIZE	INSIDE DIM.			DIM UNDER GLASS	DIA COVER OPENING	MTNG HOLE SIZE	WEIGHT (LBS)
		W	L	D				
XJKGCH N4	4	9 1/2	11 1/2	6 1/8	6 7/8	9	7/16	39 1/2
XJKAGCH N4	4	9 1/2	11 1/2	8 1/2	8 7/8	9	7/16	43 1/2

NOMINAL DIMENSIONS

CAT. NUMBER	CONDUIT SIZE	INSIDE DIM.		DIAMETER COVER OPENING	MOUNTING HOLE SIZE	WEIGHT (LBS)
		Dia.	D			
XJWHGCH N4	2 1/2	6 7/8	4 1/4	6 7/8	7/16	9
XJWTGCH N4	2	5 3/8	3 3/4	5 3/8	3/8	8

NOMINAL DIMENSIONS (XJWHGCH & XJWTGCH)

CAT NUMBER	A	B	C	D	E	F	G	H	J	K	L
XJWHGCH N4	7 3/4	7 3/4	6 3/8	6 3/8	7/16	5 5/8	4 1/16	1 13/16	1 3/4	7 7/8	5 1/4
XJWTGCH N4	6 1/4	6 1/4	5 1/8	5 1/8	3/8	5 1/8	4	1 1/2	1 7/16	6 3/8	4

CERTIFICATIONS

Class I, Div. 1, Groups B, C, D
Class II, Groups E, F, G
NEMA Type 4

UL 1203
CSA C22.2 No. 25 & 30
UL 50

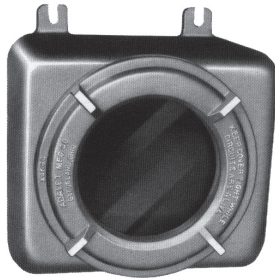
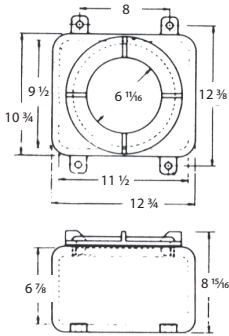

XJKGCH N4
XJKAGCH N4

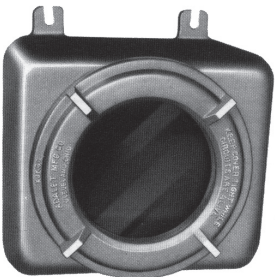
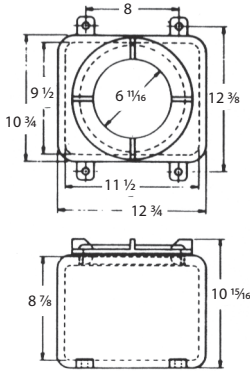

XJKAGCH N4
XJKAGCHX N4

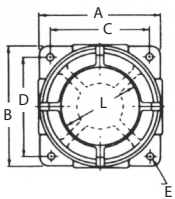

XJWHGCH N4
XJWHGCHX N4

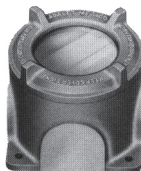
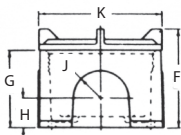

XJWTGCH N4
XJWTGCHX N4

EXPLOSIONPROOF
METER HOUSINGS